



SCINTILLA MEDIUM

Piero e Livio Castiglioni, 1972

The absolutely novel Scintilla system combines the essential versatility of a decorative lamp and a lighting capacity comparable to a technical system. The great success of this system persuaded the company to design a free-standing version in the early eighties, with the main structure fastened to the base and stem in metal.

Wall lamp with diffused and dimmable light. Chromed metal frame. The lamp is supplied with two different diffusers: one in clear borosilicate glass and the other in sandblasted borosilicate glass. Available separately a reflector made of anodized aluminum that produces indirect light. Bulb not included.

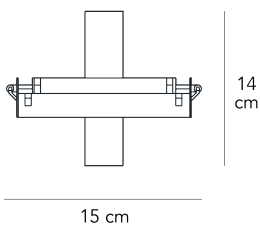

MADE IN

IT

MATERIAL DESCRIPTION

metal, glass

DIMMER

Dimmable

COLOR DESCRIPTION SKU

chrome

CERTIFICATIONS

CE **EAC** **IP20**

GROUP TENSION

Bulb

COLOR



ENERGY CLASS

A+ >> E

RECOMMENDED SOURCE

HA 1x120W R7s/80 (2900K, 2250Lm)

SKU

FP15045250CRNE