

STIPO 1.0 / 2.0

INSTALLATION INSTRUCTIONS | APRIL 2022

Fix to the base plate

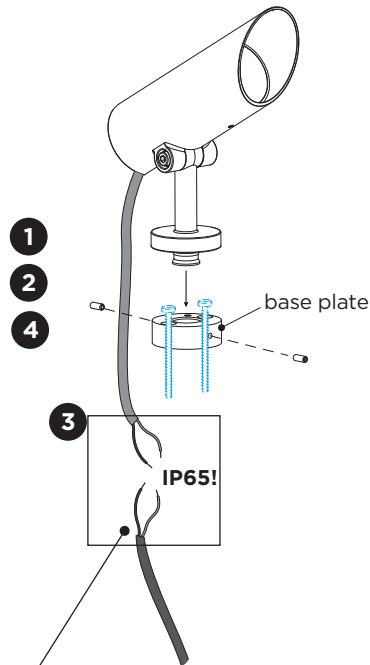

Fix to the groundspike

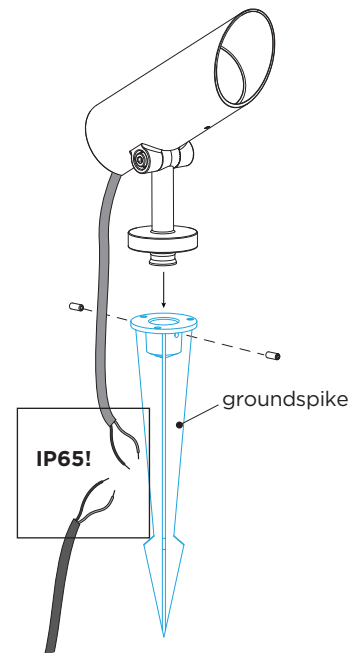

DIMENSIONS

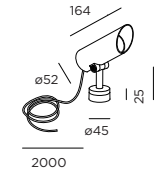

STIPO 1.0

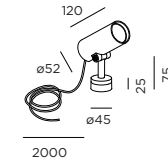

STIPO 2.0

MOUNTING INSTRUCTION

- 1 Remove the base plate by loosening the side screws.
- 2 For using base plate: fix the base plate to the ground with screws (screws are not included).

For using groundspike : stick the groundspike into the ground and mount the fixture on the groundspike with the side screws. The base plate is not needed.

3 POWER CONNECTION

Connect to 220-240V. Connect the wires with the waterproof connectors. Please see the detail method in the separate instruction sheet of waterproof connection. Make sure to use a waterproof connection with the same IP rating as the luminaire.

- 4 Fix the luminaire to the base plate with the side screws.

Included:

waterproof connectors:



Optional:

IP68 connection box:

order ref. 73240706 = 2 WAYS 2x1,5 Ø6-8mm

base plate dimensions

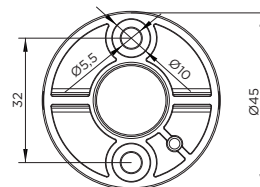

groundspike dimensions

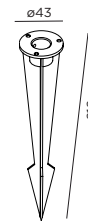

STIPO 1.0 / 2.0

INSTALLATION INSTRUCTIONS | APRIL 2022

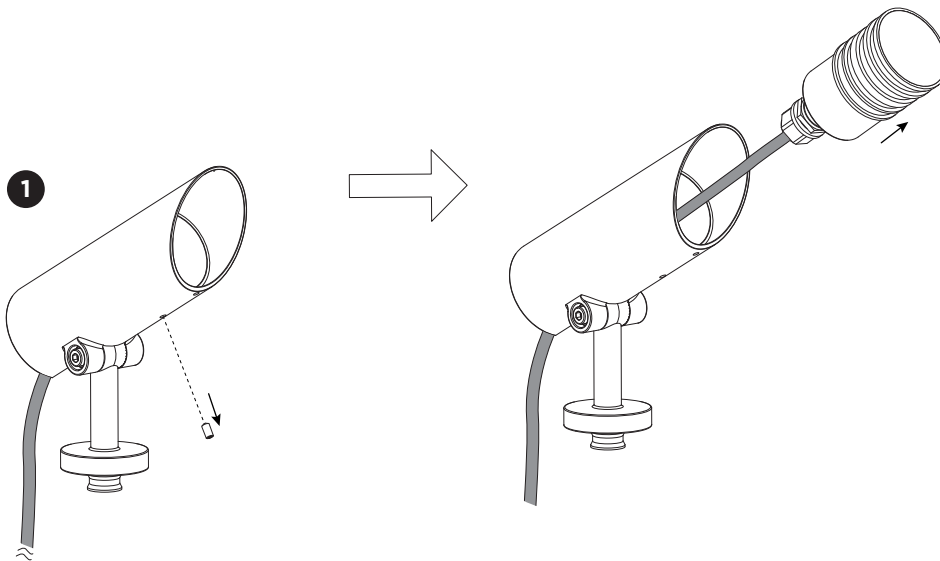

DISMOUNTING INSTRUCTION

Light source

- 1 Loosen the screw and remove the LED engine from the pole by pushing the cable into the bollard.

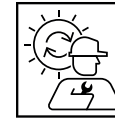

To replace the light source please contact your Wever & Ducré customer service contact point.



This luminaire contains a light source with the energy class F.