

# FLOS

03.4532.B1 White

## Kap Ø 80 Fixed Optic Flood

Designed by FLOS Architectural, 2017



Recessed luminaire with LED light source. Power supply not included. Diffusing lens included.

Are you a professional and your project needs consulting and support?

[BOOK AN APPOINTMENT](#)

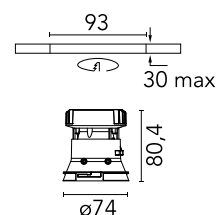

### Main specifications

|                   |                     |
|-------------------|---------------------|
| Mounting          | Ceiling recessed    |
| Environments      | Indoor dry location |
| Light Source Type | LED                 |
| LED type          | LED array           |
| Lamp category     | LED                 |
| Iicos             | No                  |
| Bulb finish       | Clear               |
| Number of heads   | 1                   |
| Power (W)         | 9.2                 |
| System power (W)  | 9.2                 |
| Source flux (lm)  | 956                 |
| System flux (lm)  | 715                 |
| Efficacy (lm/W)   | 77                  |

### Physical

|                     |       |
|---------------------|-------|
| Colour              | White |
| Trim                | No    |
| Orientation         | Fixed |
| Recessed depth (mm) | 91    |
| Spot diameter (mm)  | 74    |
| Net weight (kg)     | 0.24  |
| IP internal         | 20    |
| IP external         | 54    |

### Download

Mounting instructions [↓ PDF](#)

### Photometric Files

LDT / IES [↓ ZIP](#)

### Technical Drawings

2D [↓ ZIP](#)

3D [↓ ZIP](#)

[↓ ZIP](#) Bim



## Schematic light drawing

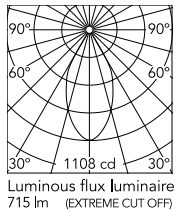

| h(m) | E(lx) | D(m) |
|------|-------|------|
| 1    | 1108  | 0.93 |
| 2    | 277   | 1.86 |
| 3    | 123   | 2.79 |
| 4    | 69    | 3.72 |
| 5    | 44    | 4.65 |

## Ecodesign and Energy Labelling

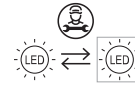

Replaceable (LED only)  
light source by a  
professional



Replaceable control  
gear by a professional

## Photometric

|                          |           |
|--------------------------|-----------|
| Lighting type            | Direct    |
| Light distribution       | Symmetric |
| CCT (K)                  | 3000      |
| CRI>                     | 90        |
| McAdam steps (SDCM)      | 3         |
| LED Life / Failure Ratio | L80B50    |
| Beam angle C0-180 (°)    | 50        |
| Beam angle C90-270 (°)   | 50        |
| UGR <sub>L</sub>         | 19        |

## Electrical

|                     |   |
|---------------------|---|
| Insulation class    | III   |
| Frequency (Hz)      | 0   |
| Main voltage (Vac)  | 18  |
| Forward voltage (V) | 18.2  |
| LED current (mA)    | 500   |
| Driver              | Remote excluded   |
| Dimmable            | Yes   |
| Dimming type        | Non Dimmable,<br>Dimmable DALI 2,<br>Dimmable 0-10V,<br>Dimmable Casambi,<br>Dimmable 1-10V,<br>Dimmable DALI 1,<br>Mains Cut Dimming |
| Emergency type      | No  |

## Notes

Diffusing lens included.

## Accessories & Power Supply

Max.  $\varnothing$ 123



$\varnothing$ 93



REQUIRED  
Frame

Installation

08.9102.00

Installation frame No Trim



REQUIRED  
Power supply

Electrical

60.9188

Continuous current power supply of 13-20W, 110\*/240V - 50/60Hz with power current selected through adjustable 200 mA - 13W / 300 mA - 15W / 350 mA - 18W / 400 / 450 / 500 / 550 / 600 / 650 / 700 / 750 / 800 / 850 / 900 mA - 20W. switch. 0/1-10V or push...



REQUIRED  
Power supply

Electrical

60.9207

Continuous current power supply, dimmable Casambi, 220/240V - 50/60Hz, 300mA - 16W / 350mA - 18,5W / 400mA - 21,5W / 450 mA - 24W / 500mA - 27W / 600mA - 32W / 650 mA - 35W / 700 mA - 36W /750 /800 /900 /1000 /1050 /1200 mA - 38W.



REQUIRED  
Power supply

Electrical

60.9411

Continuous current power supply, 1-10V, regulable trailing & leading edge dimming (mains dimming) 220/240V - 50/60Hz, 500mA - 10W.



REQUIRED  
Power supply

Electrical

60.9768

Non dimmable continuous current power supply of 220/240V - 50/60Hz with power current selected through adjustable with DIP-switch 350 mA - 7,3W / 400mA - 8,4W / 450 mA - 9,4W / 500 mA - 10,5W



REQUIRED  
Power supply

Electrical

60.9826

Continuous current power supply of 12-20W, 110/240V - 50/60Hz with power current selected through DIP-switch 350mA - 15W / 500mA - 21W / 600mA - 26W / 700mA - 30W dimmable Dali 1, Dali 2 & PUSH

