

# FLOS

03.8156.14.1V Black

## Spot 120 Dimmable 1-10V

Designed by FLOS Architectural, 2017



Accent lighting LED module.

Are you a professional and your project needs consulting and support?

[BOOK AN APPOINTMENT](#)

### Main specifications

Mounting	Track
Environments	Indoor dry location
Light Source Type	LED
LED type	LED array
Lamp category	LED
Iicos	No
Bulb finish	Clear
Number of heads	1
Power (W)	12.5
System power (W)	12.5
Source flux (lm)	921
System flux (lm)	599
Efficacy (lm/W)	47.92

### Physical

Colour	Black
Trim	No
Orientation	Adjustable
Rotation (°)	360
Longitudinal tilting (°)	90
Spot diameter (mm)	46
Length (mm)	178
Net weight (kg)	0.29
IP internal	20
IP external	20

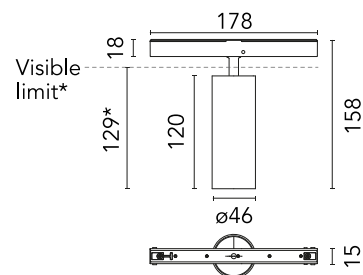

\*installed in The Tracking Magnet

### Download

Mounting instructions [↓ PDF](#)

### Photometric Files

LDT / IES [↓ ZIP](#)

### Technical Drawings

2D [↓ ZIP](#)

3D [↓ ZIP](#)

[↓ ZIP](#) Bim



## Schematic light drawing

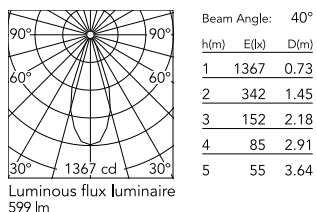

## Photometric

Lighting type	Direct
Light distribution	Symmetric
CCT (K)	2700
CRI>	90
McAdam steps (SDCM)	2
LED Life / Failure Ratio	L80B50
Beam angle C0-180 (°)	40
Beam angle C90-270 (°)	40
UGR <sub>L</sub>	17

## Electrical

Insulation class	III
Forward voltage (V)	48
LED voltage Vf (Vdc)	48
LED current (mA)	350
Driver	Remote excluded
Dimmable	Yes
Dimming type	Dimmable 1-10V
Dimming range (%)	10-100
Dimming interface	Remote Dimmable (Dimmer Not Included)
Emergency type	No

## Ecodesign and Energy Labelling



Replaceable (LED only) light source by a professional

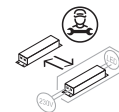

Replaceable control gear by a professional

## Notes

Accessories included (honeycomb and screening crosspiece). Only compatible with 1-10V profile version.